

London's Finest Properties

LIFE
Residential

BALTIMORE TOWER

LONDON, EC3

Rental Opportunity



AN ICONIC NEW LANDMARK FOR LUXURY LIVING CREATING A NEW FOCUS ON CANARY WHARF'S WORLD FAMOUS SKYLINE

Set to become a new landmark for luxury living, Baltimore Tower presents executive suites and 1-4 bedroom apartments, rising up to 450ft above Canary Wharf. Each with their own private balcony, the finishes of these premier apartments will be matched by a host of exclusive amenities.





BALTIMORE
TOWER

SPECIFICATIONS

General Specification

- Matt brilliant white painted walls and smooth ceilings.
- Natural oak hardwood door linings, architraves and skirtings.
- Extended height oak veneered internal doors.
- Brushed stainless steel door furniture including lever door handles with square shaft and rose.
- Brushed metal switch and socket plates.
- Programmable mood lighting to principal living area and all bedrooms.
- Colour video security entry phone system.
- Recessed downlight low energy light fittings with white bezels.
- Thermostatically controlled central heating via conventional radiators with additional comfort cooling to living/dining areas and all bedrooms.
- Pressurised hot and cold water supplies.
- Double glazing throughout.

Kitchen Area

- Bespoke kitchens by leading interior design specialist Rabih Hage.
- Engineered one strip oak veneer flooring.
- White high gloss lacquered kitchen unit doors with concealed handles.
- Coloured natural stone worktop with coloured glass splashback.
- Smeg stainless steel fully integrated electric appliances to include:- single low level oven, 5 ring ceramic hob, cooker hood, washer/drier (freestanding if within utility cupboard off hallway), dishwasher, fridge/freezer, microwave.
- Stainless steel bowl and a half under-mounted sink with square profile monobloc mixer tap and grooved worktop drainer.
- Wall unit under lighting.
- Centralised appliance isolator switch panel.

Living / Dining Room

- Engineered one strip oak veneer flooring.
- Pair of stereo ceiling speakers connected to recessed wall mounted i-Pod docking station to dining area.
- Four surround sound ceiling speakers connected to input socket at TV location to living room (for resident to provide amplifier etc).
- TV socket set to living room (Sky+) subject to subscription. All TV socket sets to include digital radio and terrestrial sockets.
- Telephone socket to living/dining area.
- Programmable mood lighting.

Bedroom

- Quality oatmeal coloured carpet with underlay.
- Floor to ceiling fitted wardrobe with oak veneered doors to all bedrooms.
- Stereo ceiling speakers connected to recessed wall mounted i-Pod docking station to all bedrooms.
- TV socket set to all bedrooms (Sky) subject to subscription. All TV socket sets to include digital radio and terrestrial sockets.
- Telephone extension socket to all bedrooms.
- Programmable mood lighting.

Apartment Hallway and landing

- Engineered one strip oak veneer flooring.
- Audio/visual entryphone system connected to communal entrance door.

Bathrooms / Shower Room

- Large format natural marble floor and fully tiled walls.
- Electric mat underfloor warming.
- Plumbing concealed (where possible) with stone vanity tops.
- Oak framed recess with mirrored cabinet, mirror and feature downlight.
- Shaver socket.
- White bathroom suite featuring shower tray or steel bath as appropriate, back to wall WC, concealed dual flush cistern and square profiled semi-recessed basin.
- Chrome plated square profile taps, bottle trap, cistern push plate, thermostatic bath filler/shower mixer, shower rail, handset and hose.
- Coloured glass bath panel.
- Chrome plated square profile thermostatic electric heated towel rail.
- Clear glass frameless bath screen.

Cloakroom

- Large format natural marble floor tiles.
- Large format tiles to ducting and splashback to basin.
- White sanitaryware featuring hand rinse basin and back to wall WC with dual flush concealed cistern.
- Chrome plated square profile monobloc tap.
- Mirror over basin.
- Chrome plated square profile thermostatic electric heated towel rail.

Communal Areas

- Double height communal entrance foyer featuring large format tile flooring, contemporary furnishings, wall finishes and feature lighting.
- Stair core access to basement level, walls to be matt Gardenia paint finish with floor screed painted to match carpet colour.
- Lift to all apartment entrance levels & lower ground parking.
- Low energy wall light fittings.
- Communal secure cycle storage.

Secure Car Parking

- Valet parking service to and from secure lower ground levels.



TRANSPORT LINKS

Connect from Crossharbour



Thames Clippers operate scheduled services from Canary Wharf Pier to Waterloo and Westminster in around 30 minutes, with peak hour shuttles to London Bridge in 13 minutes.

Residents at Baltimore Tower will be brilliantly placed for every form of transport across the Capital, the UK and Europe.

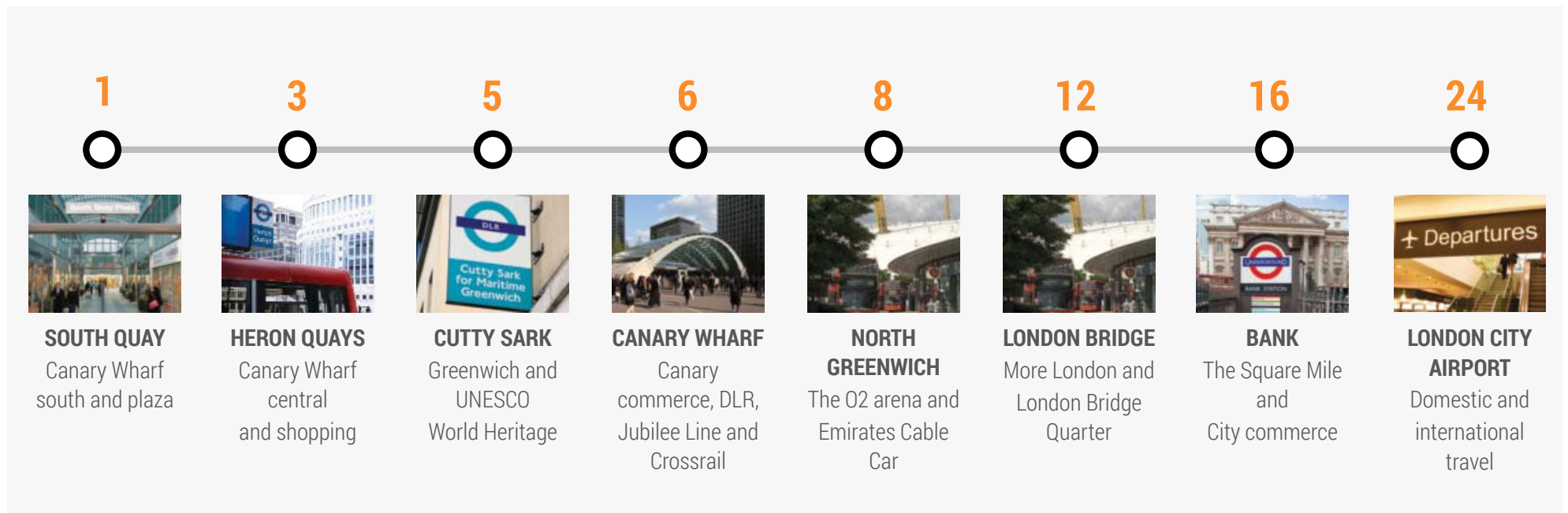

Canary Wharf is the hub of one of the most dynamic transport infrastructures in the world

Residents at Baltimore Tower will connect within 2 minutes walk at Crossharbour

THE DLR

This highly automated network links the Capital's financial centres, Royal Greenwich and London City Airport in minutes.

JUBILEE LINE

London's most advanced tube line and service connects at Canary Wharf for direct travel to Westminster and The West End.

MAINLINE

London Bridge handles over 54 million passengers a year with mainline and Thameslink services departing every 3 minutes. It is the fourth busiest hub in the UK.

CROSSRAIL

This new super highway across the Capital will have an interchange at Canary Wharf, significantly cutting journey times when operational from 2017.

CABLE CAR

The new Emirates Airline links London's largest entertainment venues - crossing the river in just 5 minutes with cars running every 30 seconds.



Canary Wharf is a driving force for London having the largest city GDP in Europe

The spectacle of Canary Wharf now encompasses over 97 acres of breathtaking architecture, advanced communications and global headquarters.

The district has amassed one of the most prestigious lists of banks and financial institutions see anywhere in the world.

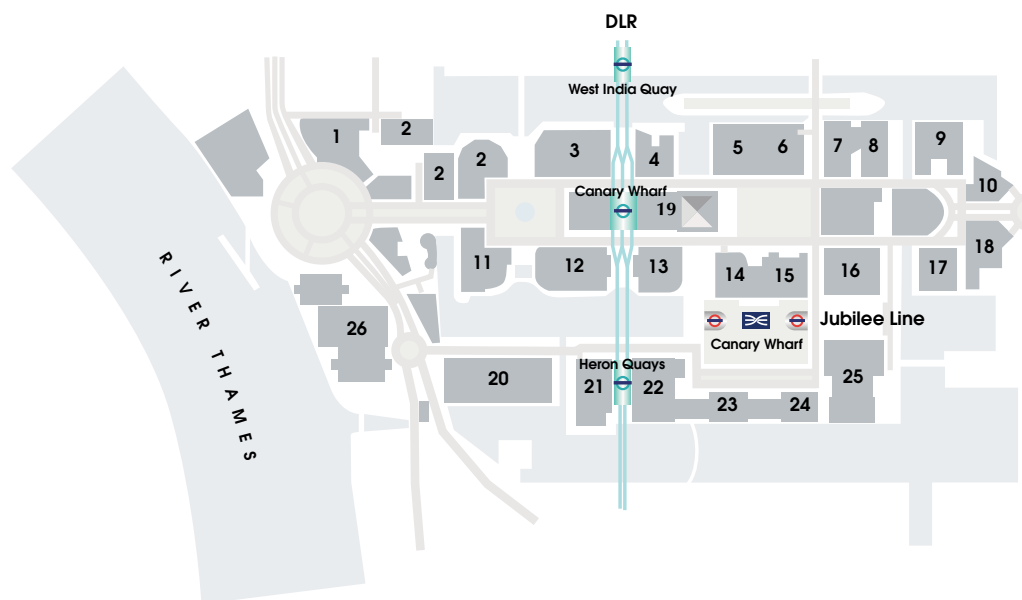

1. WESTFERRY CIRCUS
Chevron, Venues,
De Vere, Morgan Stanley
European Medicines Agency

**2. COLUMBUS COURTYARD
& ONE CABOT SQUARE**
Credit Suisse

**3. 10 CABOT SQUARE /
NORTH COLONNADE**
Ogilvy & Mather, Barclays

4. 24 NORTH COLONNADE
Financial Services Authority

5. 5 CANADA SQUARE
Bank of America, Credit Suisse

6. 8 CANADA SQUARE
HSBC

7. 15 CANADA SQUARE
KPMG

8. 30 NORTH COLONNADE
Fitch Ratings, Algorithmics

9. ONE CHURCHILL PLACE
Barclays, BGC International, LOCOG

10. 5 CHURCHILL PLACE
ME Global, JP Morgan

11. 25 CABOT SQUARE
Morgan Stanley

**12. 20 CABOT SQUARE/SOUTH
COLONNADE**
Barclays, Capital

13. 30 SOUTH COLONNADE
Thompson Reuters

14. 33 CANADA SQUARE
Citi

15. 25 CANADA SQUARE
Major commerce and institutions

16. 20 CANADA SQUARE
McGraw Hill, BP, Standard & Poor's

18. 20 CHURCHILL PLACE
State Street

19. ONE CANADA SQUARE
Major commerce and institutions

20. 1 BANK STREET
Future development

21. 20 BANK STREET
Morgan Stanley

22. 25 BANK STREET
J P Morgan

23. 40 BANK STREET
Major commerce and institutions

24. 50 BANK STREET
Northern Trust, Goldenberg Hehmeyer
& Co.

25. UPPER BANK STREET
Clifford Chance, FTSE, Infosys, LOCOG,
Mastercard, Total

26. RIVERSIDE SOUTH
Future development for J P Morgan



“Canary Wharf could double in size over the next decade as the next phase of its development moves forward.”

- Over 93,000 people already work in and commute to Canary Wharf daily.
- The district offers some 15 million sq ft of office and retail space and remains one of the most highly specified urban areas in the world.
- There are 4 retail malls with over 200 quality boutiques, brand name shops, bars & restaurants.
- Canary Wharf remains the fastest growing business district in the UK with an ever expanding corporate and business community set to double in the new phased future build programme.
- Canary Wharf has its own conference and banqueting & arts centre.
- Landscaped open space exceeds 20 acres.
- The continuous expansion of Canary Wharf has become the catalyst for the transformation of the Royal Victoria Docks to the east, the Greenwich Peninsula and the resurgence of Greenwich itself to the South.
- Canary Wharf Group have recently acquired the adjoining 17 acre Wood Wharf estate to further expand this dynamic district.

THE CANARY LIFESTYLE ON YOUR DOORSTEP

London is the world's busiest international gateway and remains the premier financial capital alongside New York and Tokyo. Residents at Baltimore Tower can enjoy crossing the metropolis in minutes, whether for its financial districts, perhaps afternoon tea at Claridges, or a little brand name indulgence on Bond Street - the connections are all there, so too easy access to London's most sought after and world renowned universities.

London's greatest experiences, its Royal parkland, its thousand years of heritage and pageantry, its world class entertainment and diverse array of cultural landmarks are all within 30 minutes of Baltimore Tower.



**Average journey times in minutes
from Canary Wharf to principal
destinations:**

The O2 Arena (<i>& Emirates cable car to ExCeL</i>)	2
Maritime Greenwich	9
Waterloo (<i>The London Eye</i>)	9
Bank (<i>The City</i>)	11
Leicester Square (<i>Theatreland</i>)	20
Temple (<i>LSE</i>)	21
Tottenham Court Rd (<i>Oxford St & Soho</i>)	22
Goodge Street (<i>UCL</i>)	23
Covent Garden	24
Kings Cross/St Pancras (<i>Eurostar</i>)	24
Knightsbridge (<i>Harrods</i>)	24



**London's principal universities -
average journey times in minutes
from Canary Wharf:**

King's College, Waterloo Campus <i>Nearest tube: Waterloo</i>	9
London School of Economics <i>Nearest tube: Temple</i>	21
University of Westminster, Cavendish Campus <i>Nearest tube: Goodge Street</i>	23
University College London <i>Nearest tube: Goodge Street</i>	23
Imperial College <i>Nearest tube: South Kensington</i>	26



THE DEVELOPMENT

Baltimore Tower provides a choice of brilliantly designed and proportioned suites and 1, 2 & 3 bedroom apartments arranged from level 2 upwards. All apartment styles have a steel and glass formed balcony which varies in size as the apartment levels rise and rotate slightly to create the Tower's distinctive flowing twist.

At levels 43 to 45, the Tower features a split level brasserie, bar and restaurant providing a fabulous and exclusive setting for anything from casual drinks to formal dining with stunning vistas across Canary Wharf's iconic skyline.

Residents will also have an exclusive private lounge and large screen cinema room at lower level.



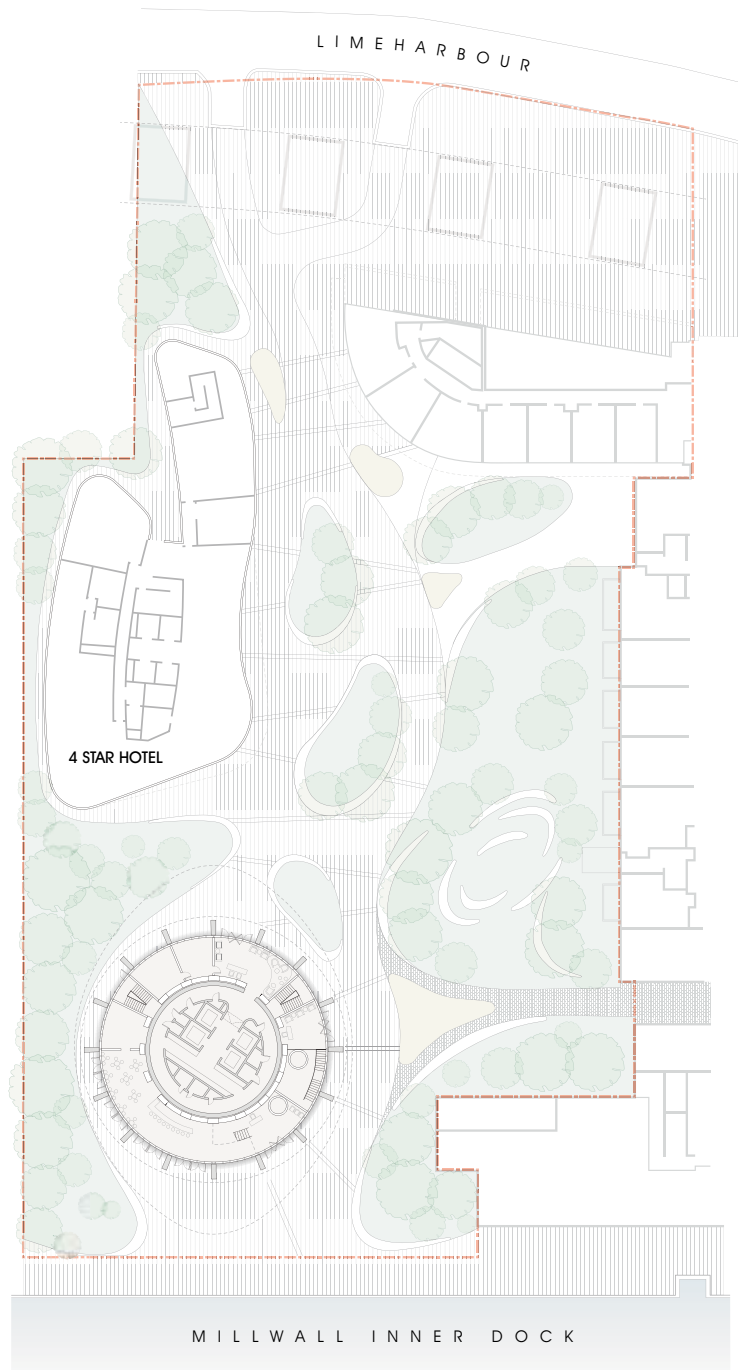

The Tower has been designed by the world renowned architects Skidmore, Owings & Merrill, to provide a visually stunning 45 storey tower that has a changing array of perceptual effects as the sun moves around its curving form. The tower will have two lower levels which integrate within the overall scheme providing valet parking and other planned facilities for residents.

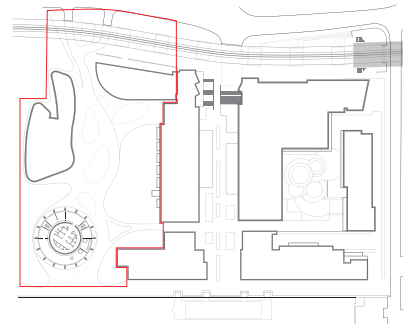

GROUND LEVEL

- Reception foyer.
- Concierge and security.
- Café, bar and restaurant.
- Residential lobby.
- Lift lobby and mail suite.

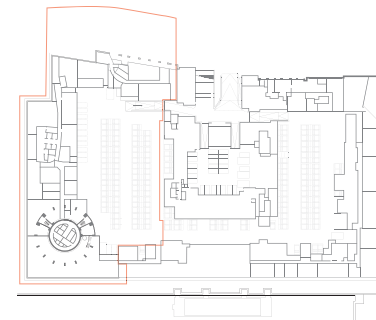

FIRST LEVEL

- Access to lower level parking.
- Access to The Club health and fitness complex.
- Access to residents' private lounge and large screen cinema room.

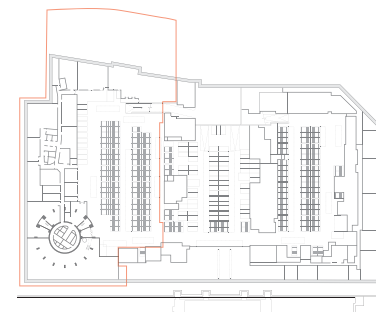

SECOND LEVEL

- Access to lower level parking.
- Access to The Club health and fitness complex.

All facilities are planned, but are subject to change and enhancement during architectural finalisation.

FLOOR PLANS

2 bedroom apartment

Total areas: 68-69 sq.m. 729-740 sq.ft.

Principal room dimensions

Living/dining inc kitchen	5.0 x 6.3m 16'5" x 20'7"
Master bedroom	2.7 x 4.7m 8'10" x 15'5"
Bedroom	2.2 x 3.3m 8'6" x 10'9"





Suite

Total area: 33.5-34 sq.m. 362-366 sq.ft.

Principal room dimensions

Living area 5.0 x 6.3m 16'5" x 20'7"

Dining/
bedroom area 2.7 x 4.7m 8'10" x 15'5"

1 Bed apartment

Total area: 50-51.5 sq.m. 541-556 sq.ft.

Principal room dimensions

Living dining
inc kitchen 4.8 x 8.0m 15'9" x 26'2"

Bedroom 3.3 x 3.5m 10'9" x 11'5"

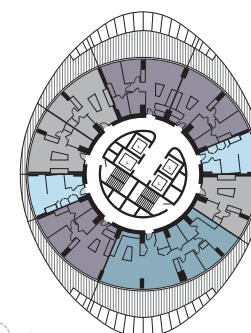

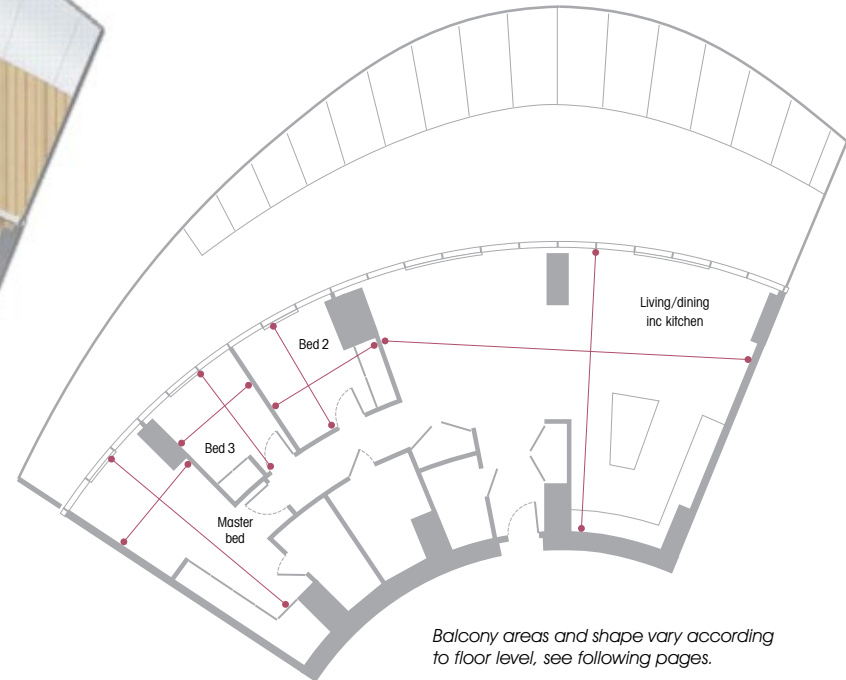
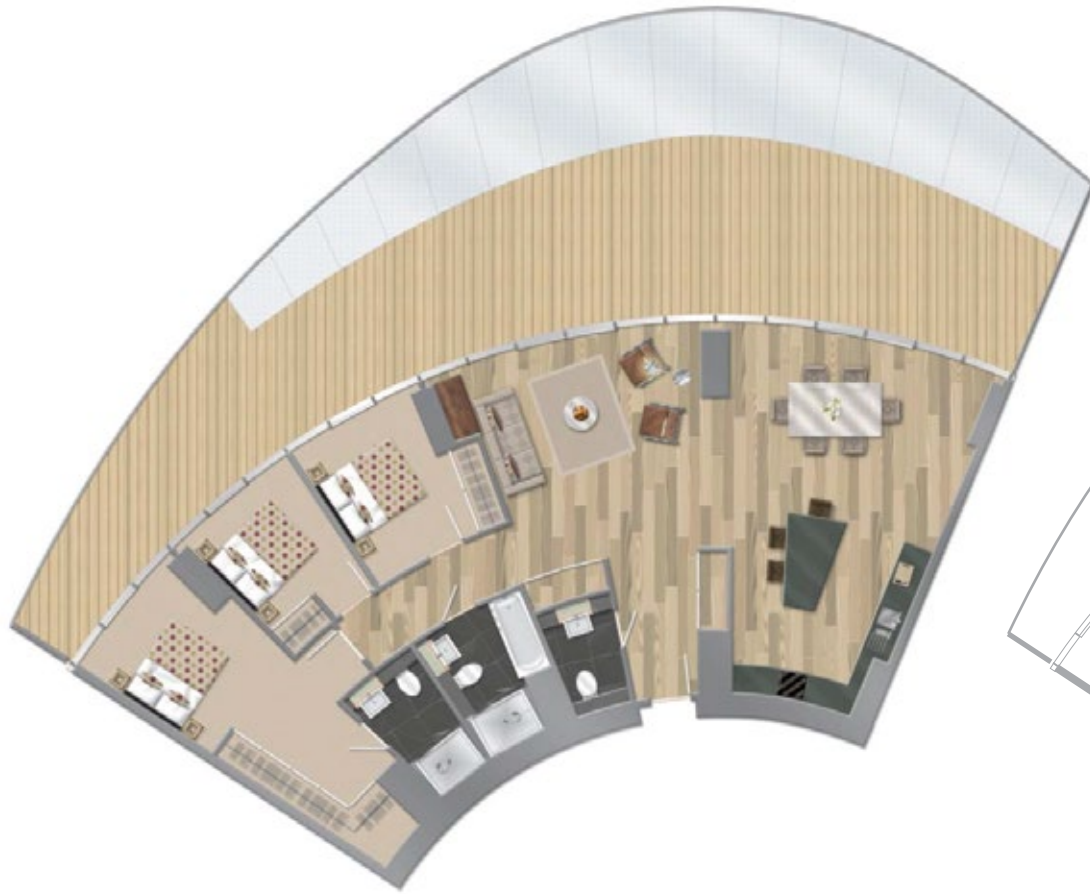

Balcony areas and shape vary according to floor level, see following pages.

3 bedroom apartment

Total area: 119-121 sq.m. 1275-1298 sq.ft.

Principal room dimensions

Living/dining inc kitchen	10.5 x 8.0m 34'4" x 26'2"
Master bedroom	3.0 x 6.6m 9'9" x 21'6"
Bedroom 2	3.4 x 3.4m 11'2" x 11'2"
Bedroom 3	2.6 x 3.4m 8'6" x 11'2"

Floor finishes and furniture shown on apartment plans are for illustrative purposes only. Floor plan layouts are deemed to be correct but may vary during architectural finalisation of the Tower. All room dimensions are approximate, total areas vary nominally according to floor level and apartment location. Balcony areas vary at all floor levels according to rotation of balcony ring.

TOWER ORIENTATION

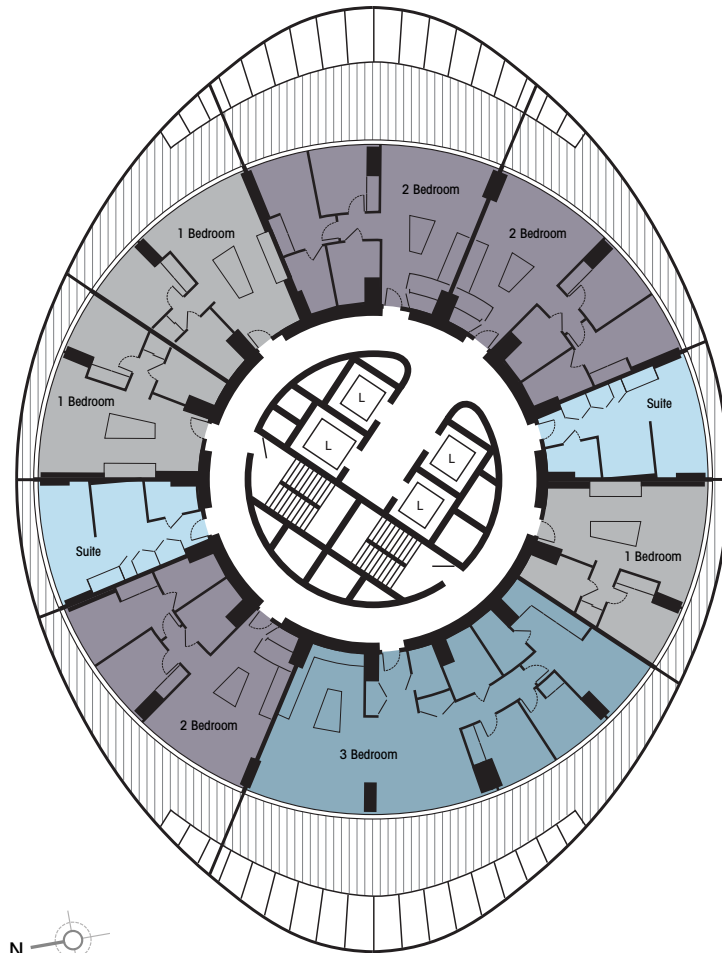

Q U A Y S I D E

M I L L W A L L I N N E R D O C K

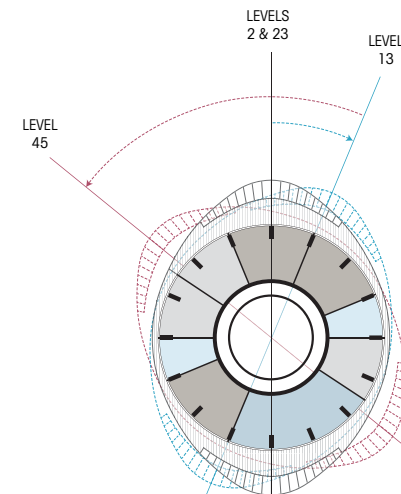

The design and visual spectacle of Baltimore Tower is unique. From levels 2 to 37 the apartment arrangement remains identical with the exception of the outer balcony 'ring' that shifts and steps by nominal degrees reaching its furthest point to the right at level 13 where it then starts its return to the centre line (at level 23) and continues to its furthestmost point on the left at levels 44 & 45.

This innovative momentum provides variable solar shading and cover for each floor level, in turn generating an enhanced environmental performance while creating the building's distinctive visual twist.

In addition to the movement of the balcony ring, the centre apartment core also rotates at levels 8, 22 and 29 to correspond with the alignment of the balcony ring.

There are nine apartments on each floor from levels 2 to 37 as shown opposite (with the exception of level 21 which is plant).



APARTMENT LEVELS 2-9

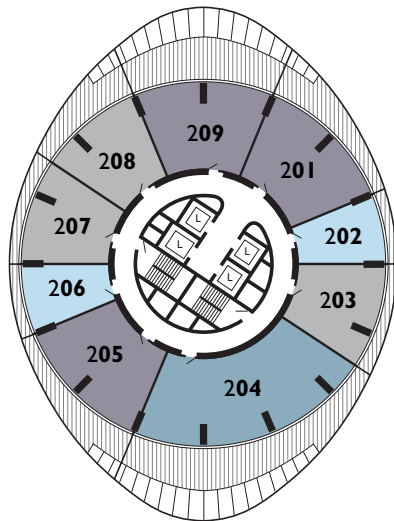

2

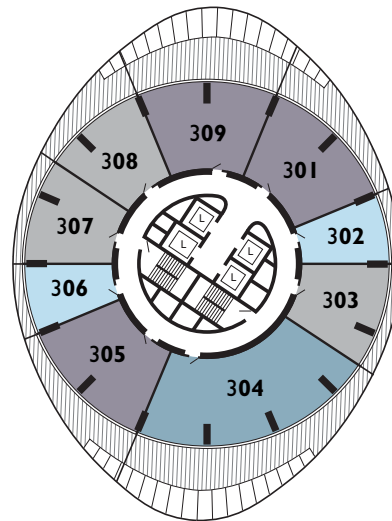

3

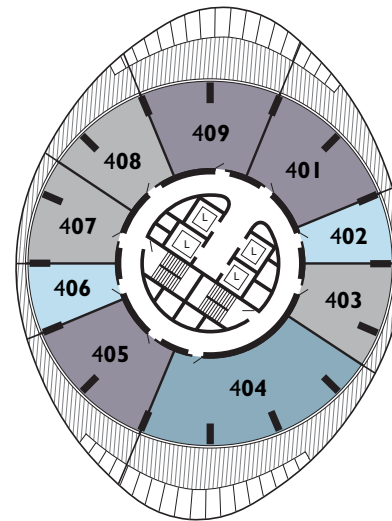

4

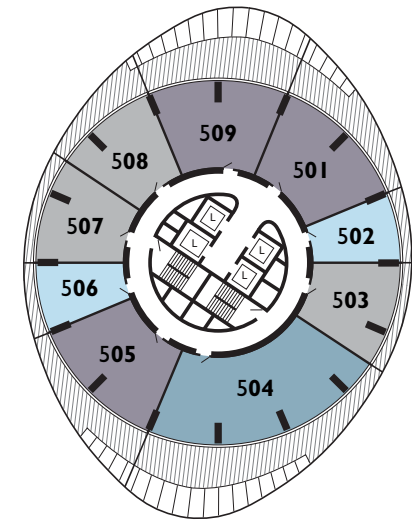

5

MILLWALL INNER DOCK



- Suite
- 1 bedroom apartment
- 2 bedroom apartment
- 3 bedroom apartment

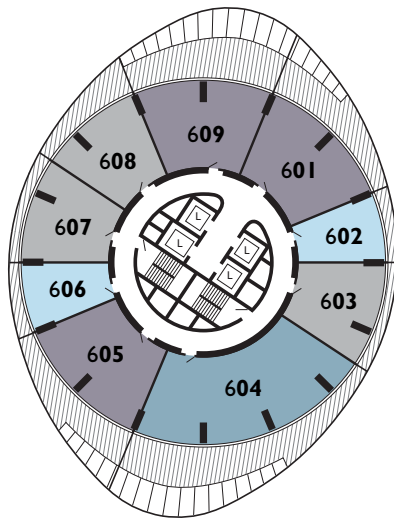

6

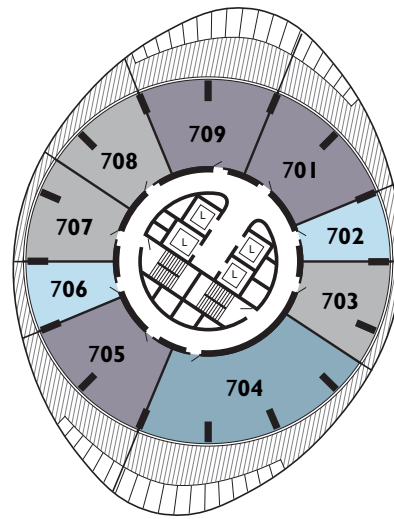

7

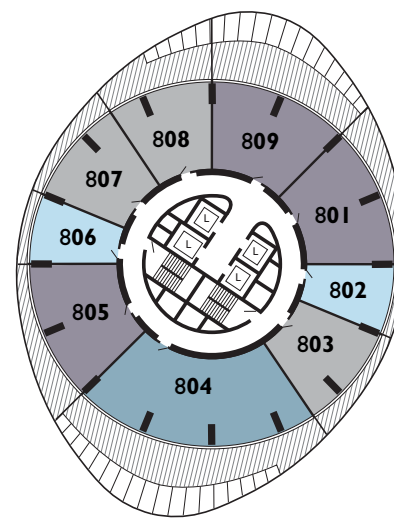

8

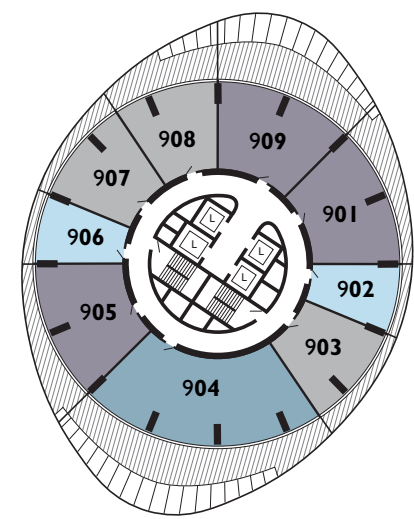

9



Suite

1 bedroom apartment

2 bedroom apartment

3 bedroom apartment

APARTMENT LEVELS 10-17

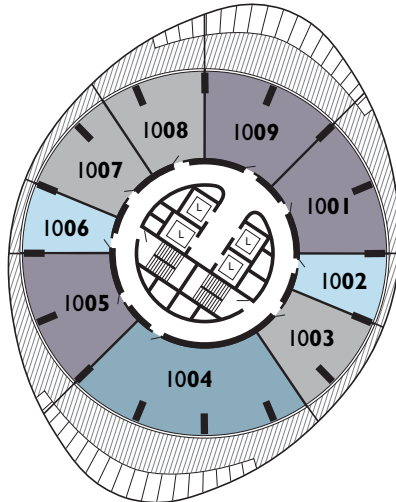

10

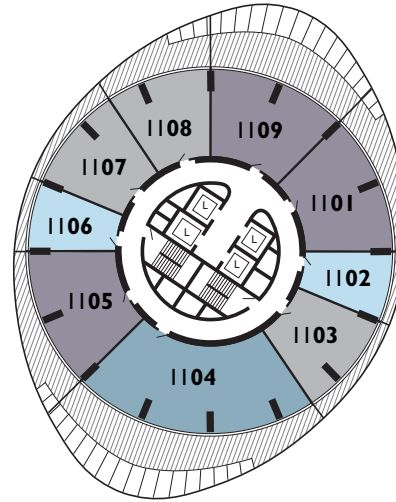

11

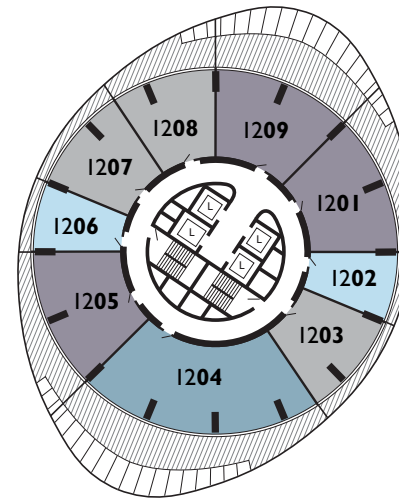

12

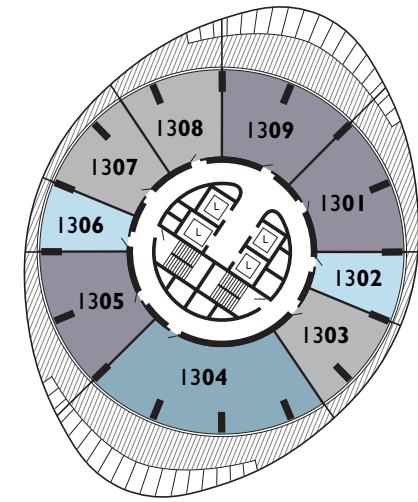

13

MILLWALL INNER DOCK



- Suite
- 1 bedroom apartment
- 2 bedroom apartment
- 3 bedroom apartment

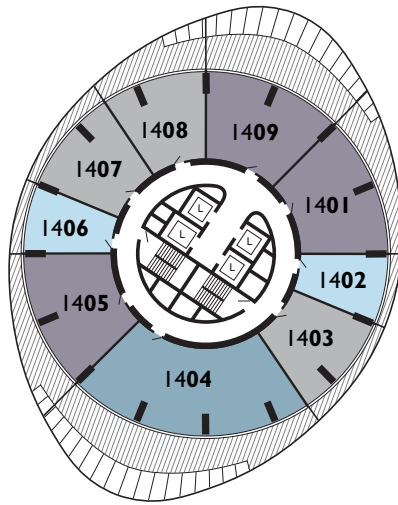

14

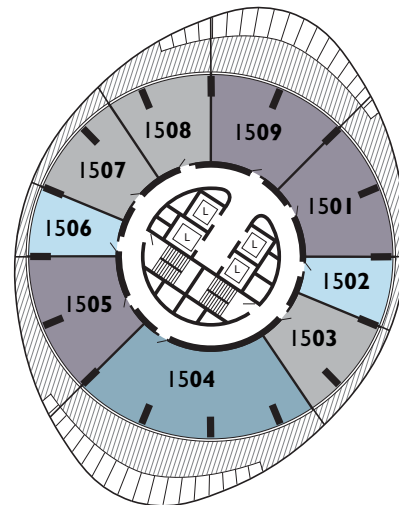

15

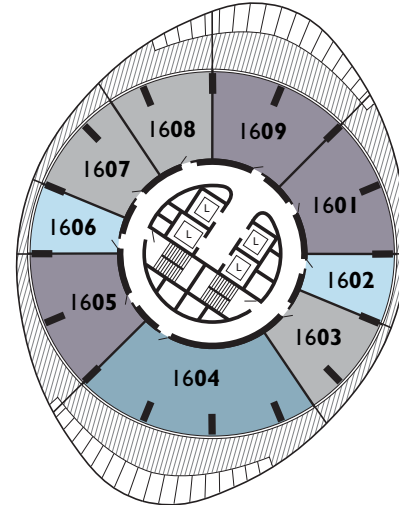

16

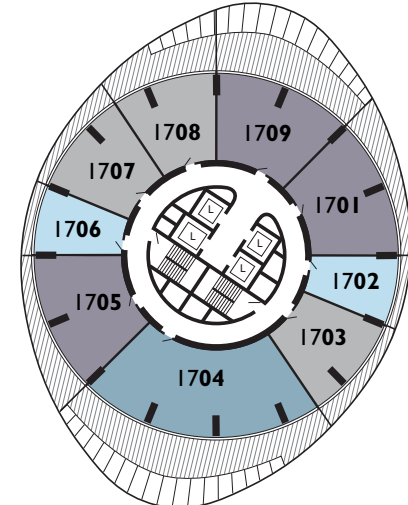

17



Suite

1 bedroom apartment

2 bedroom apartment

3 bedroom apartment

APARTMENT LEVELS 18-25

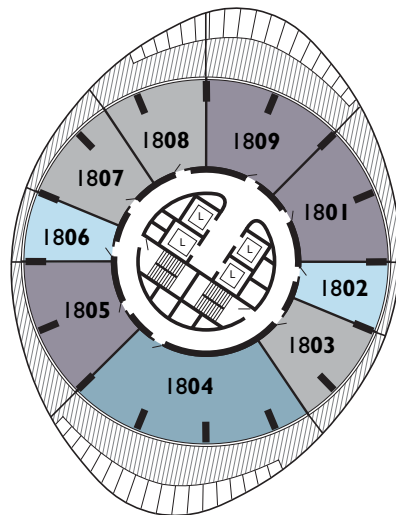

18

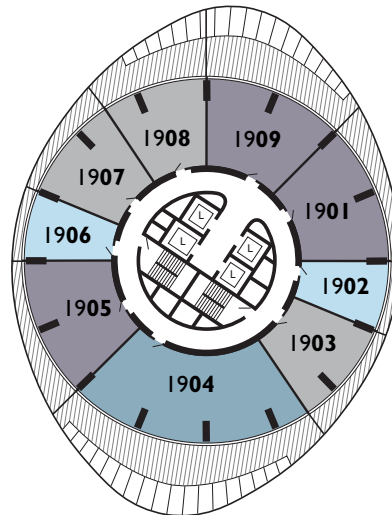

19

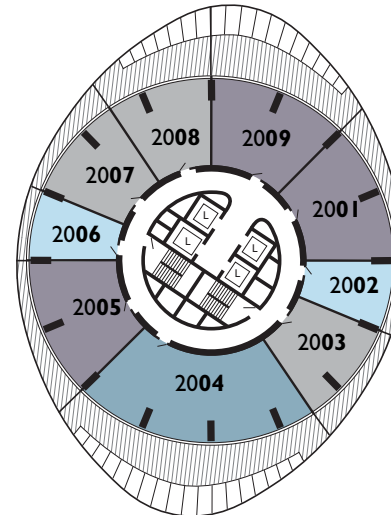

20

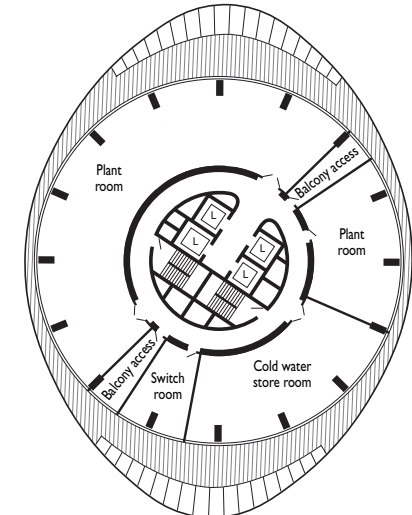

21

MILLWALL INNER DOCK



- Suite
- 1 bedroom apartment
- 2 bedroom apartment
- 3 bedroom apartment

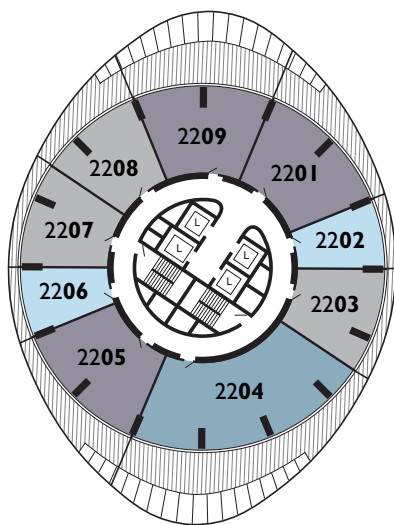

22

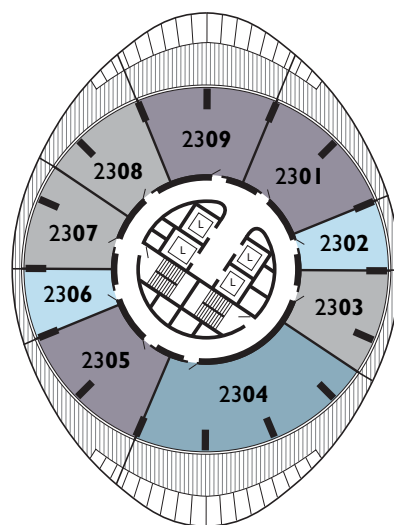

23

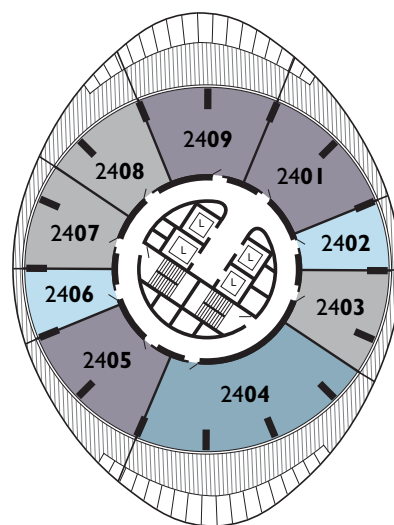

24

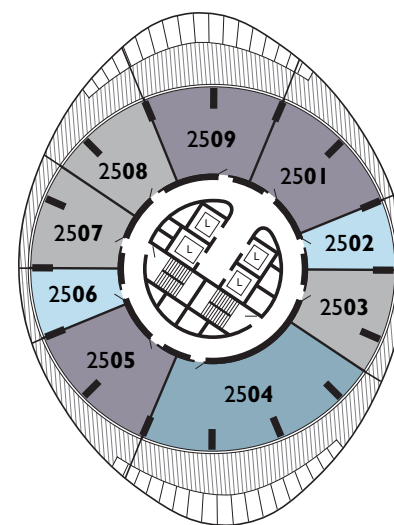

25



 Suite

 1 bedroom apartment

 2 bedroom apartment

 3 bedroom apartment

APARTMENT LEVELS 26-33

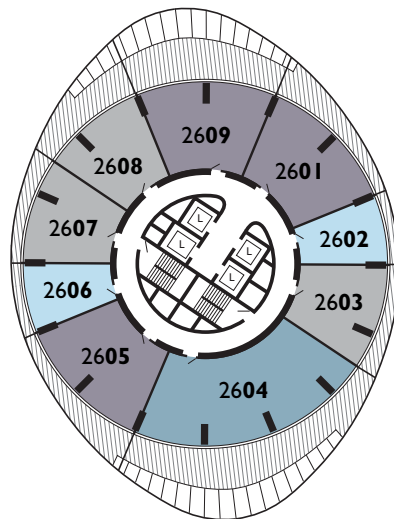

26

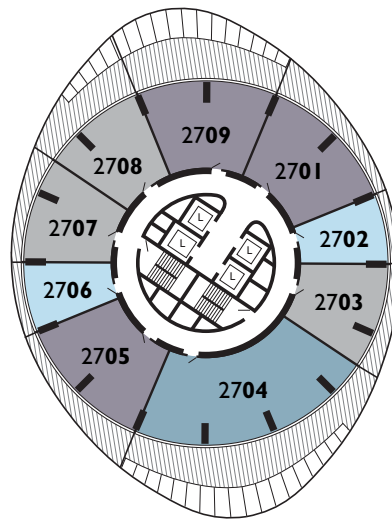

27

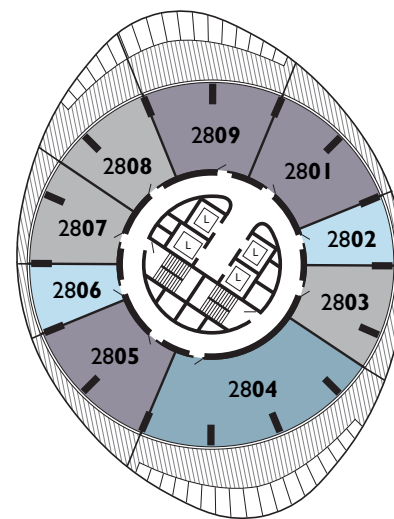

28

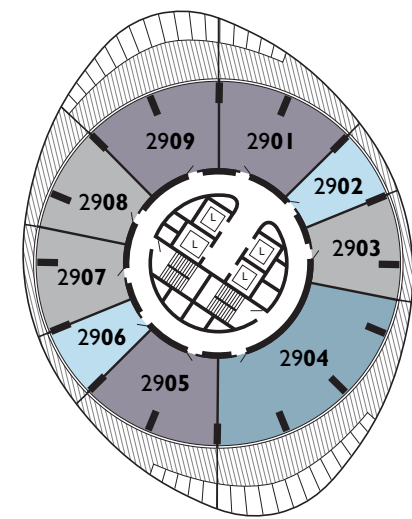

29

MILLWALL INNER DOCK



- Suite
- 1 bedroom apartment
- 2 bedroom apartment
- 3 bedroom apartment

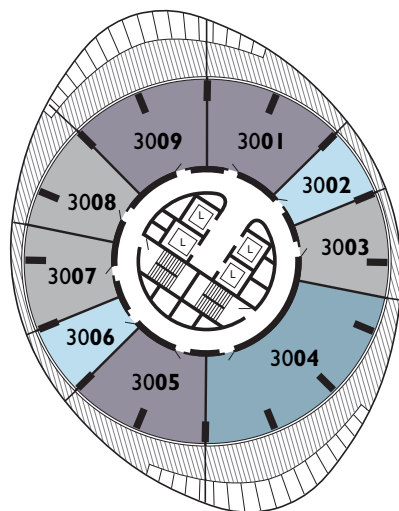

30

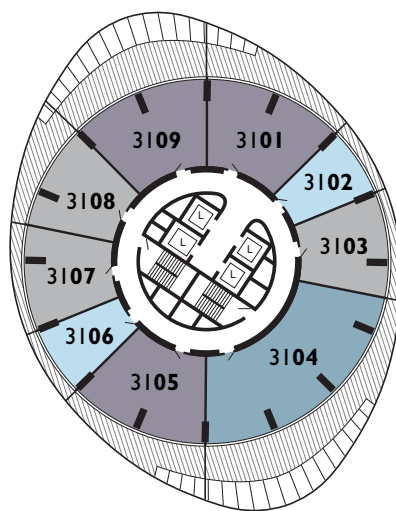

31

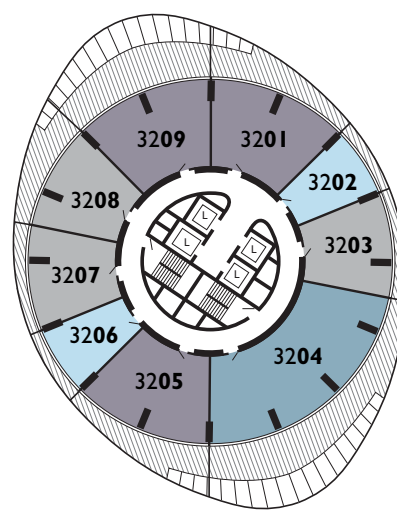

32

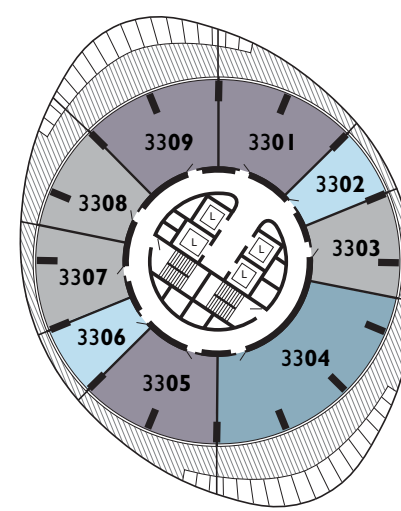

33



Suite

1 bedroom apartment

2 bedroom apartment

3 bedroom apartment

APARTMENT LEVELS 34-37



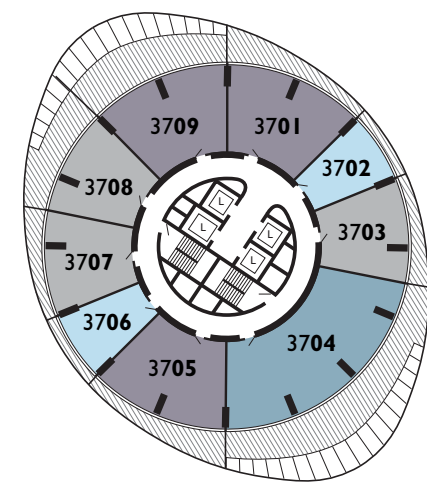
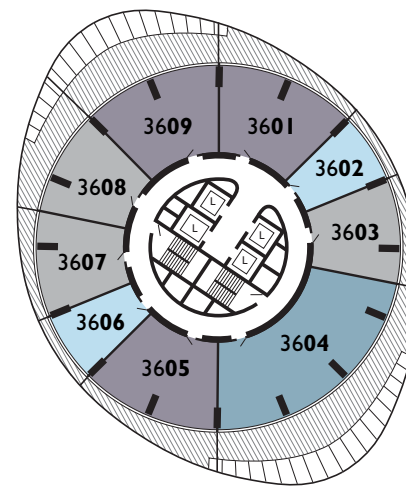
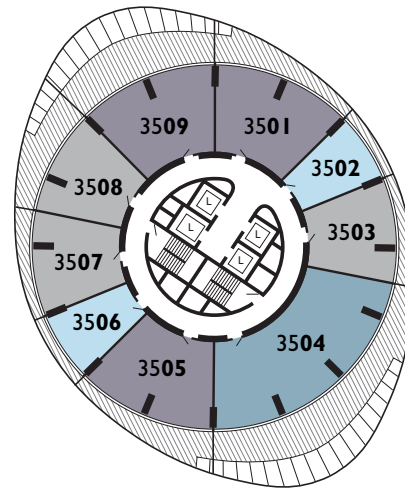
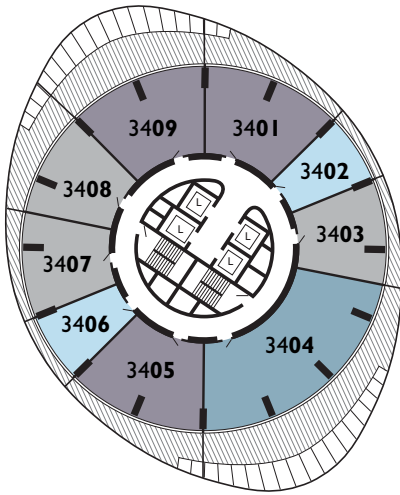

MILLWALL INNER DOCK



Suite

1 bedroom apartment

2 bedroom apartment

3 bedroom apartment

RESTAURANT LEVELS 43-45



The sky level restaurant is planned to have a highly acclaimed and renowned brand operator to add the pinnacle of exclusivity to Baltimore Tower. With a split level restaurant, vast al-fresco terrace and double height ceiling void, the restaurant will be the new 'place to be and be seen' on the London high life scene.

Residents will have full access to this gastro experience whether for casual drinks with friends or formal dining overlooking Canary Wharf's dramatic skyline. The setting and ambience some 450 feet above the quayside will ensure Baltimore Tower's place amongst the Capital's premier restaurants.

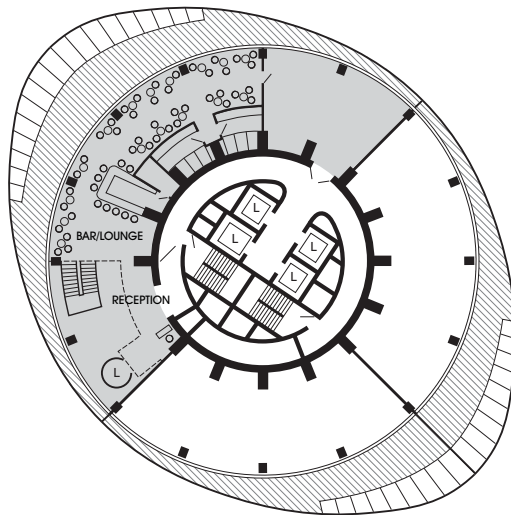

43

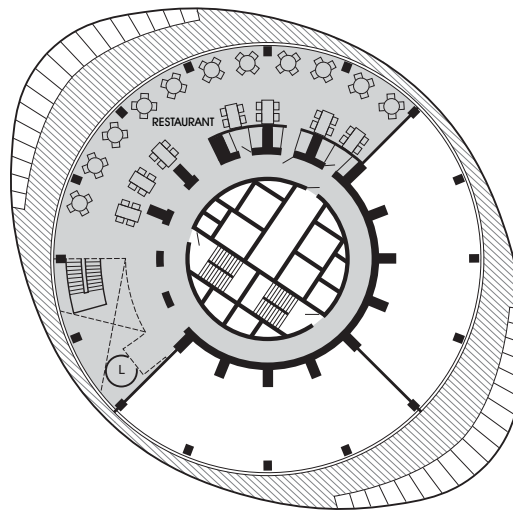

44

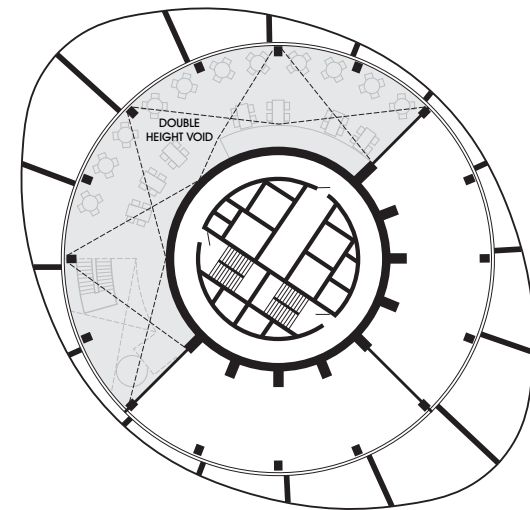

45





EXCLUSIVE STYLE INSPIRATIONAL DINING & SWEEPING VISTAS

THE BRASSERIE & BAR WITH A TWIST



TOWER SKY LEVEL

Brasserie • Bar • Restaurant
Levels 43 - 45



TOWER GROUND LEVEL

Café • Bar • Restaurant
Levels G - 1



QUAYSIDE

Lotus Chinese classic cuisine
Floating restaurant



FURNITURE PACK

OPTION I



new **CONCEPT** **INTERIORS**
CORPORATE COMPLETE



www.newconceptinteriors.com

ONLINE

We invite you to visit our new look website which has been optimised for a range of devices including smartphones and tablets to keep up to pace within this fast growing industry.

Aside from the new fresh and subtle feel of the website we have added new ranges of interior services that are offered by our curtains, window blinds and upholstery departments.

To find all the latest information, new portfolios and upcoming events please visit our website www.newconceptinteriors.com.

Alternatively you can search for us on Facebook, follow us on Twitter via @ncifurniture and NewConceptInteriors on Instagram.

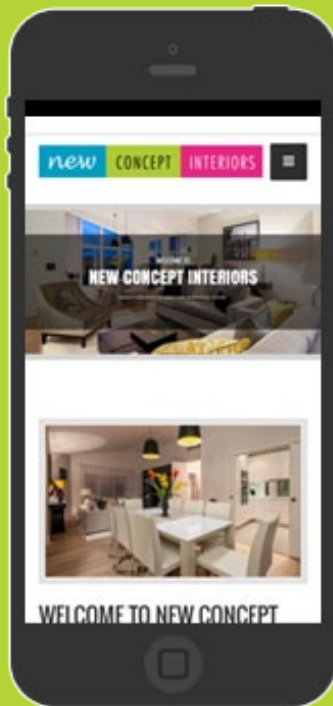

ABOUT NEW CONCEPT INTERIORS

With over 30 years of experience in the buy to let property investment market New Concept Interiors offer a product and service unmatched by its competitors, dealing closely with some of London's leading property developers including Galliard Homes.

Coming from a background of retail soft furnishings, New Concept Interiors have used their expertise and experiences in this area to build an extensive portfolio of furnishings from rental apartments through to bespoke refurbishment schemes.



Our unique developer association gives us the insight to fully understand how to maximise the use of space, light and contemporary furnishings to create a truly superior interior ambiance that will ensure the optimum long term rental income for landlords and a sophisticated home for tenants alike. Creating and manufacturing of inspired designs allows us to cater for all the necessary requirements of both tenants and owner occupiers.

Our furniture packages have a proven success record in offering a product that is robust and durable whilst remaining a front runner with our own unique designs. Unlike the majority of our competitors, we design and produce most of our furniture in-house which arrives from our factory pre-assembled.

New Concept Interiors have successfully furnished over 3000 apartments within the last decade and we expect continued growth with an unprecedented number of apartments in the pipeline for 2016.

Our vision is simple "to deliver a quality product, in budget and on time, every time giving our customers a service second to none."

Andrew Block
Business Development Director



THE CORPORATE COMPLETE PACKAGE

Our updated and rebranded perennial favourite, the Corporate Complete has proven to be a great success in ensuring a prompt letting of rental properties.

The Corporate Complete Package includes upholstered dressings and artwork through to bathroom accessories to make this a real one stop turnkey solution.







CORPORATE COMPLETE STUDIO INVENTORY

Living Room Inventory

- 1 - Two Seater Upholstered Sofa
- 3 - Scatter Cushions
- 1 - Media Unit
- 1 - Coffee Table
- 1 - 'C' Type Side Table
- 1 - 60cm Chrome & Glass Dining Table
- 2 - Upholstered Dining Chairs
- 1 - Table Lamp
- 1 - Floor Lamp
- 1 - Large Mirror
- 1 - Framed Wall Art
- 1 - Floor Rug
- 1 - Waste Bin
- Made to Measure Blinds

Bedroom 1 Inventory

- 1 - 5'0" Upholstered Divan Bed
- 1 - 5'0" Upholstered Headboard
- 1 - 5'0" Mattress - 1500 Pocket Sprung
- 2 - Bedside Tables
- 2 - Bedside Lamps
- 1 - Padded Bed Throw
- 4 - Scatter Cushions
- 1 - Kingsize Bedding Pack*
- 1 - Waste Paper Bin
- 12 - Coat Hangers
- 1 - Hairdryer
- 1 - Large Framed Mirror
- 1 - Framed Artwork
- Made to Measure Blinds

Dressing & Accessories

- 1 - Fire Blanket
- 1 - Kitchen Pack (SEE PAGE 12)
- 1 - Bathroom Pack (SEE PAGE 13)
- 1 - Entertainment Package (SEE PAGE 13)

*INCLUDES MATTRESS PROTECTOR, FITTED SHEET, DUVET, DUVET COVER, 4 X PILLOW CASES & 4 PILLOWS





CORPORATE COMPLETE 1, 2, AND 3 BEDROOM INVENTORY

Living Room Inventory

- 1 - Three Seater Upholstered Sofa
- 1 - Occasional Chair
- 4 - Scatter Cushions
- 1 - Upholstered Footstool
- 1 - Media Unit
- 1 - Coffee Table
- 1 - 'C' Type Side Table
- 1 - 80cm Chrome & Glass Dining Table*
- 4 - Upholstered Dining Chairs**
- 1 - Table Lamp
- 1 - Floor Lamp
- 1 - Large Mirror
- 2 - Framed Wall Art***
- 1 - Floor Rug
- 1 - Waste Bin
- Made to Measure Blinds

Bedroom 1 Inventory

- 1 - 5'0" Upholstered Divan Bed
- 1 - 5'0" Upholstered Headboard
- 1 - 5'0" Mattress - 1500 Pocket Sprung
- 2 - Bedside Tables
- 2 - Bedside Lamps
- 1 - Three Drawer Chest
- 4 - Scatter Cushions
- 1 - Kingsize Bedding Pack****
- 1 - Padded Bed Throw
- 1 - Large Framed Mirror
- 1 - Framed Artwork
- 1 - Hairdryer
- 1 - Waste Paper Bin
- 12 - Coat Hangers
- Made to Measure Blinds

Bedroom 2 & 3 Inventory (if applicable)

- 1 - 4'6" Upholstered Divan Bed
- 1 - 4'6" Upholstered Headboard
- 1 - 4'6" Mattress - 1000 Pocket Sprung
- 2 - Bedside Tables
- 2 - Bedside Lamps
- 1 - Tallboy Chest
- 4 - Scatter Cushions
- 1 - Double Size Bedding Pack****
- 1 - Padded Bed Throw
- 1 - Large Framed Mirror
- 1 - Framed Artwork
- 1 - Waste Paper Bin
- 12 - Coat Hangers
- Made to Measure Blinds

*120cm DINING TABLE IN 2 & 3 BEDROOM PACKAGES

**6 DINING CHAIRS FOR 3 BEDROOM PACKAGE

*** CAN BE SUBSTITUED FOR 1 LARGER PIECE

****INCLUDES MATTRESS PROTECTOR, FITTED SHEET, DUVET, DUVET COVER, 4 X PILLOW CASES & 4 PILLOWS

Hallway

- 1 - Tall Mirror
- 1 - Framed Artwork

Accessories

- 1 - Fire Blanket
- 1 - Kitchen Pack (SEE PAGE 12)
- 1 - Bathroom Pack (SEE PAGE 13)
- 1 - Entertainment Pack (SEE PAGE 13)





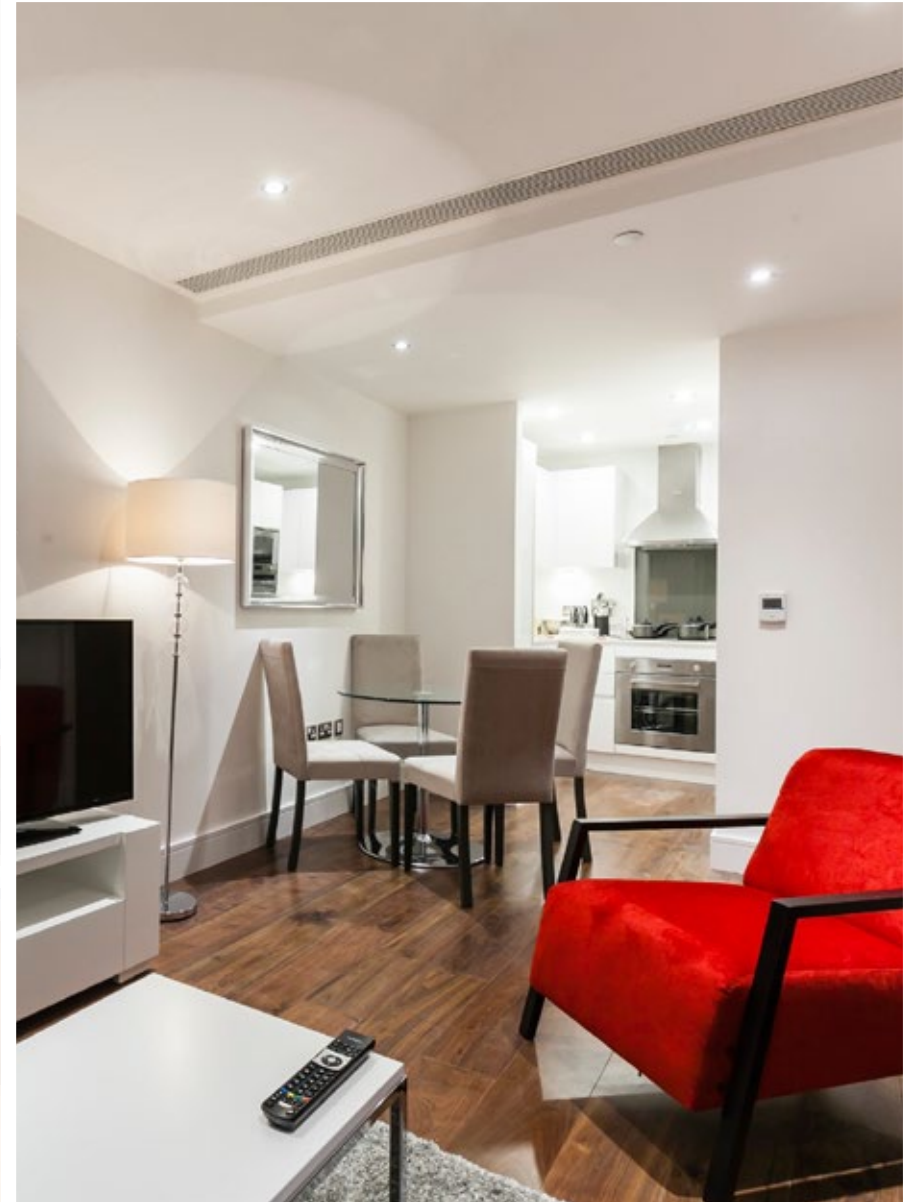

ACCESSORIES

KITCHEN PACKAGE

- 1 - 20Litre Chrome Bin (30LITRE FOR 2 & 3 BED)
- 1 - Mop
- 1 - Bucket
- 1 - Dustpan & Brush
- 1 - Broom
- 1 - Chrome Kettle
- 1 - Chrome Toaster
- 1 - Stainless Steel Cutlery Set (16 PIECE)*
- 1 - Cutting Knives Set
- 1 - Salt & Pepper Mill Set
- 1 - Kitchen Gadget Set
- 1 - Crockery Set (16 PIECE)**
- 1 - Drinking Glass Set (12 PIECES)***
- 1 - Cooking Utensil Set
- 1 - Chopping Board
- 1 - Saucepan Set (3 PIECES)
- 1 - Iron
- 1 - Ironing Board
- 1 - Vacuum Cleaner
- 1 - Grater
- 1 - Colander
- 1 - Coffee Maker Machine
- 4 - Placemats (6 FOR 2 & 3 BED)
- 4 - Coasters (6 FOR 2 & 3 BED)
- 1 - Wire Sieve
- 2 - Baking Trays (3 FOR 3 BED)
- 2 - Pyrex Dishes
- 1 - Frying Pan

*24 PIECES FOR 2 & 3 BEDROOM PACK

**24 PIECES FOR 2 BED PACK & 32 PIECES FOR 3 BED PACK

***18 PIECES FOR 2 BED PACK & 24 PIECES FOR 3 BED PACK



BATHROOM PACKAGE

Inventory (per bathroom)

- 1 - Chrome Toilet / Brush Holder
- 1 - Toilet Roll Storage Spike
- 1 - 5 Litre Chrome Bin

ENTERTAINMENT PACKAGE

- 1 - 40" LCD TV - Full HD
- 1 - Blu-Ray Player
- 1 - HDMI Lead
- 1 - Aerial Lead

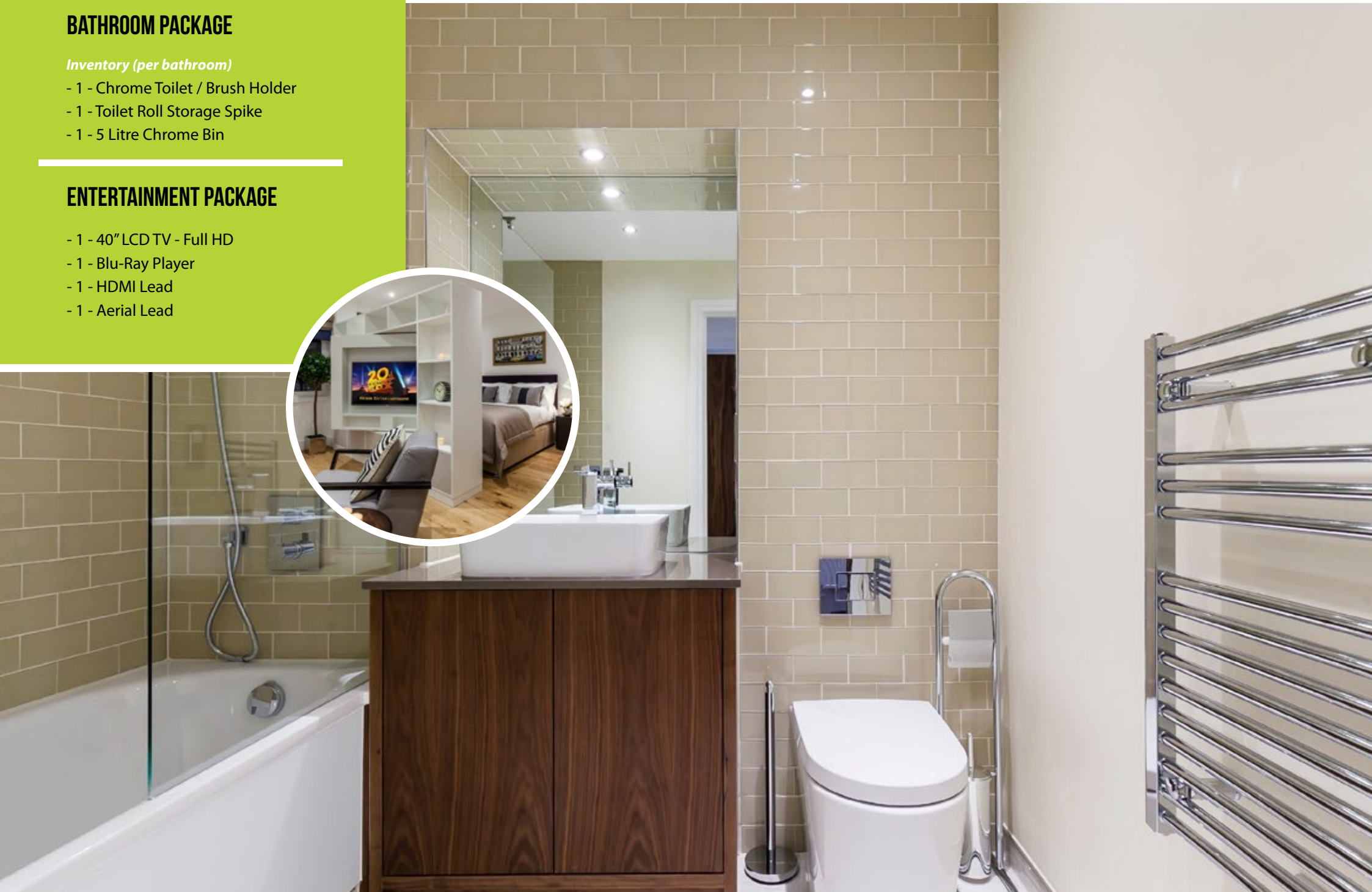



MATTRESSES

Upgraded mattresses are available from which will provide a fantastic nights sleep. With 1500 pocket springs and a memory foam layer sewn in, the mattress provides great stability balanced with amazing comfort.

SOFA BEDS

Often used as a way to maximise the rental potential of an investment property, our sofa beds are made to an extremely high specification. Using a two fold super smooth mechanism the sofa bed can be ready for use in a matter of seconds. Various sizes are available.

FLOOR RUGS

A luxurious floor rug can add fashion and warmth to any room. We have a wide range of contemporary hand woven rugs available.





LAMPS

The simple use of lighting can add a sense of warmth necessary to create a beautiful ambience. A range of upgraded lamps are available for viewing on our website.

WALLART

Often overlooked as an unnecessary luxury, wall art can have a massive impact to an interior design. With the help of our interior design team we have introduced a new range of interesting framed wall art that will add glamour to any apartment.

RESPONE SOFAS

With our in-house team of dedicated upholsterers we manufacture each luxury piece to the highest standards using handwork frames and the best quality components. We have a large range of fabrics for you to choose from, or alternatively you may wish to supply your own.



FURNITURE PACK

OPTION 2



new CONCEPT INTERIORS
CORPORATE ESSENTIAL



www.newconceptinteriors.com

ONLINE

We invite you to visit our new look website which has been optimised for a range of devices including smartphones and tablets to keep up to pace within this fast growing industry.

Aside from the new fresh and subtle feel of the website we have added new ranges of interior services that are offered by our curtains, window blinds and upholstery departments.

To find all the latest information, new portfolios and upcoming events please visit our website www.newconceptinteriors.com.

Alternatively you can search for us on Facebook, follow us on Twitter via @ncifurniture and NewConceptInteriors on Instagram.

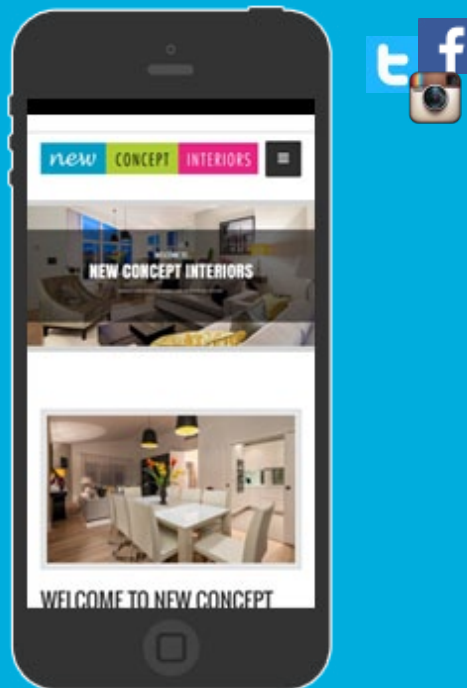

ABOUT NEW CONCEPT INTERIORS

With over 30 years of experience in the buy to let property investment market New Concept Interiors offer a product and service unmatched by its competitors, dealing closely with some of London's leading property developers including Galliard Homes.

Coming from a background of retail soft furnishings, New Concept Interiors have used their expertise and experiences in this area to build an extensive portfolio of furnishings from rental apartments through to bespoke refurbishment schemes.



Our unique developer association gives us the insight to fully understand how to maximise the use of space, light and contemporary furnishings to create a truly superior interior ambiance that will ensure the optimum long term rental income for landlords and a sophisticated home for tenants alike. Creating and manufacturing of inspired designs allows us to cater for all the necessary requirements of both tenants and owner occupiers.

Our furniture packages have a proven success record in offering a product that is robust and durable whilst remaining a front runner with our own unique designs. Unlike the majority of our competitors, we design and produce most of our furniture in-house which arrives from our factory pre-assembled.

New Concept Interiors have successfully furnished over 3000 apartments within the last decade and we expect continued growth with an unprecedented number of apartments in the pipeline for 2016.

Our vision is simple "to deliver a quality product, in budget and on time, every time giving our customers a service second to none."

Andrew Block
Business Development Director



THE CORPORATE ESSENTIAL PACKAGE

Our updated and rebranded perennial favourite, the Corporate Essential has proven to be a great success in ensuring a prompt letting of rental properties.

The Corporate Essential Package includes upholstered dressings and artwork through to bathroom accessories to make this a real one stop turnkey solution.







CORPORATE ESSENTIAL

STUDIO INVENTORY

Living Room Inventory

- 1 - Two Seater Upholstered Sofa
- 1 - Media Unit
- 1 - Coffee Table
- 1 - 'C' Type Side Table
- 1 - 60cm Chrome & Glass Dining Table
- 2 - Upholstered Dining Chairs
- 1 - Table Lamp
- 1 - Floor Lamp
- 1 - Large Mirror
- 1 - Framed Wall Art
- 1 - Floor Rug

Made to Measure Blinds

Bedroom 1 Inventory

- 1 - 5'0" Upholstered Divan Bed
- 1 - 5'0" Upholstered Headboard
- 1 - 5'0" Mattress - 1500 Pocket Sprung
- 2 - Bedside Tables
- 2 - Bedside Lamps
- 1 - Large Framed Mirror
- 1 - Framed Artwork

Bedding Items*

Made to Measure Blinds

Dressing & Accessories

- 1 - Entertainment Package (SEE PAGE 13)

*INCLUDES DUVET, 4 PILLOWS & MATTRESS PROTECTOR





CORPORATE ESSENTIAL 1, 2, AND 3 BEDROOM INVENTORY

Living Room Inventory

- 1 - Three Seater Upholstered Sofa
- 1 - Occasional Chair
- 1 - Upholstered Footstool
- 1 - Media Unit
- 1 - Coffee Table
- 1 - 'C' Type Side Table
- 1 - 80cm Chrome & Glass Dining Table*
- 4 - Upholstered Dining Chairs**
- 1 - Table Lamp
- 1 - Floor Lamp
- 1 - Large Mirror
- 2 - Framed Wall Art
- 1 - Floor Rug
- Made to Measure Blinds

Bedroom 1 Inventory

- 1 - 5'0" Upholstered Divan Bed
- 1 - 5'0" Upholstered Headboard
- 1 - 5'0" Mattress - 1500 Pocket Sprung
- 2 - Bedside Tables
- 2 - Bedside Lamps
- 1 - Three Drawer Chest
- 1 - Large Framed Mirror
- 1 - Framed Artwork
- Bedding Items***
- Made to Measure Blinds

Bedroom 2 & 3 Inventory (if applicable)

- 1 - 4'6" Upholstered Divan Bed
- 1 - 4'6" Upholstered Headboard
- 1 - 4'6" Mattress - 1000 Pocket Sprung
- 2 - Bedside Tables
- 2 - Bedside Lamps
- 1 - Tallboy Chest
- 1 - Large Framed Mirror
- 1 - Framed Artwork
- Bedding Items***
- Made to Measure Blinds

Hallway

- 1 - Tall Mirror
- 1 - Framed Artwork

Accessories

- 1 - Entertainment Pack (SEE PAGE 13)

*120cm DINING TABLE IN 2 & 3 BEDROOM PACKAGES

**6 DINING CHAIRS FOR 3 BEDROOM PACKAGE

***INCLUDES DUVET, 4 PILLOWS & MATTRESS PROTECTOR







ACCESSORIES



ENTERTAINMENT PACKAGE

- 1 - 40" LCD TV - Full HD
- 1 - Blu-Ray Player
- 1 - HDMI Lead
- 1 - Aerial Lead



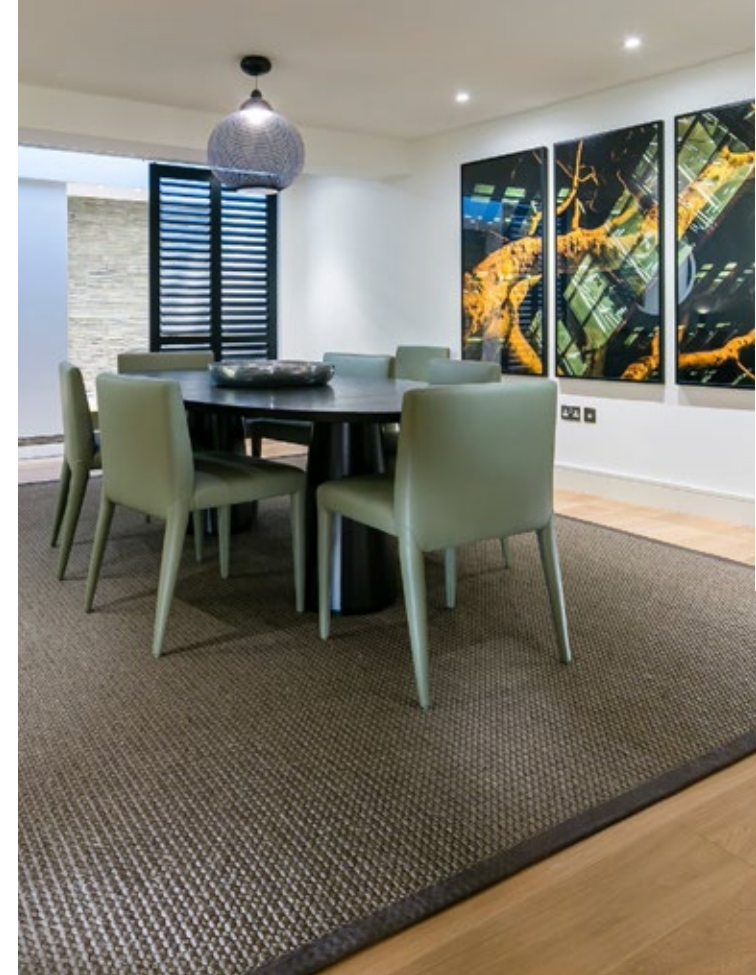

MATTRESSES

Upgraded mattresses are available from which will provide a fantastic nights sleep. With 1500 pocket springs and a memory foam layer sewn in, the mattress provides great stability balanced with amazing comfort.

SOFA BEDS

Often used as a way to maximise the rental potential of an investment property, our sofa beds are made to an extremely high specification. Using a two fold super smooth mechanism the sofa bed can be ready for use in a matter of seconds. Various sizes are available.

FLOOR RUGS

A luxurious floor rug can add fashion and warmth to any room. We have a wide range of contemporary hand woven rugs available.





LAMPS

The simple use of lighting can add a sense of warmth necessary to create a beautiful ambience. A range of upgraded lamps are available for viewing on our website.

WALL ART

Often overlooked as an unnecessary luxury, wall art can have a massive impact to an interior design. With the help of our interior design team we have introduced a new range of interesting framed wall art that will add glamour to any apartment.

RESPONSE SOFAS

With our in-house team of dedicated upholsterers we manufacture each luxury piece to the highest standards using handwork frames and the best quality components. We have a large range of fabrics for you to choose from, or alternatively you may wish to supply your own.



Head Office
Unit 2, Portal West
Business Centre
6 Portal Way
London
W3 6RU

+44 (0)20 8896 9990

Crossharbour
6 Baltimore Wharf
London
E14 9AQ

+44 (0)20 3846 3330

Canary Wharf
36 Millharbour
London
E14 9JS

+44 (0)20 3668 1030

County Hall
252 Westminster
Bridge Road
London
SE1 7PD

+44 (0)20 7620 1600

Deptford
Block A
Hudson Building
Deals Gateway
Blackheath Road
SE10 8EA

+44 (0)20 8692 2244

East London
Unit B
Westgate Apartments
14 Western Gateway
London
E16 1FD

+44 (0)20 7476 0125

Greenwich
6 Victoria Parade
Greenwich
London
SE10 9FR

+44 (0)20 8418 3609

Nine Elms – Riverside
Unit 11
Flagstaff House
St George Wharf
London
SW8 2LZ

+44 (0)20 7582 7989



North London
Unit 4
71b Drayton Park
London
N5 1BF

+44 (0)20 7359 4488

Tower Bridge – City
Spice Quay
34 Shad Thames
London
SE1 2YG

+44 (0)20 7234 0666

Westminster
23 Monck Street
London
SW1P 2AE

+44 (0)20 7222 2005

Whitehouse – Waterloo
Downstream Building
9 Belvedere Road
London
SE1 8XZ

+44 (0)20 7928 7007

Hong Kong
1508, 15/F,
100 QRC
Queen's Road Central
Hong Kong

+852 2644 0268

Singapore
1 Raffles Place
19-61 One Raffles Place
Tower 2
Singapore, 048616

+65 6808 5802

South Africa
Mandela Rhodes Place
1 Wale Street
Cape Town
South Africa, 8001

+27 21 424 396

COMING SOON:
Canning Town, E16
Limehouse, E14
Stratford, E15

